

Quick Installation Guide

Wireless HD Video Security Kit
K4W-3TC/K8W-3TC

Package contents

The K8W-3TC kit is taken as an example here. The actual product prevails.

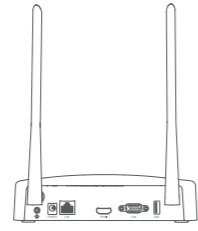

Wi-Fi Network Video Recorder (NVR) x 1

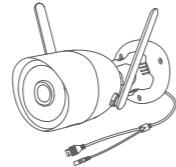

Camera x 8



Mouse x 1

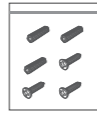

Camera installation package x 1
Anchor: Height 6.6 mm, Inner diameter 2.4 mm, Length 26.4 mm, Screw: BA3*25 mm (Head diameter: 6.0 mm)



NVR installation package x 1
Screw: BM3.0*5 mm (Head diameter: 6.0 mm, Head thickness: 2.3 mm)



Waterproof kit x 8



12 V 1 A power adapter x 8

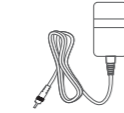

12 V 2 A power adapter x 1

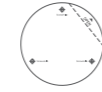

Installation template x 8



Quick installation guide x 1

Please read this guide before you start with the quick setup for this security kit upon the first use. For product or function details, please go to www.tendacn.com to download the user guide.

Appearance

▪ NVR

- LED indicator**
- Solid blue:** The NVR is initializing and starting.
 - Solid green:** The NVR is working properly and is recording.
 - Blinking green:** The NVR is working properly but is not recording.
 - Solid red:** The NVR is working abnormally. (LAN port disconnected, IP address conflict or HDD abnormality, etc.)

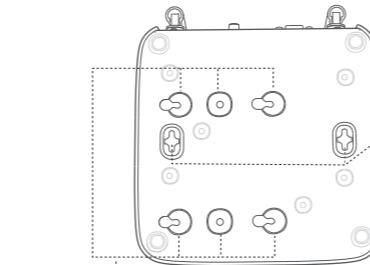
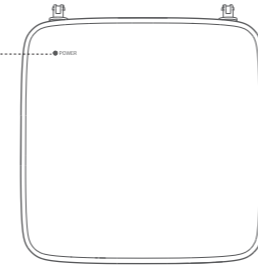

Hard disk drive (HDD) screw hole

Wall mounting hole
You may need wall mounting materials. Please prepared them by yourself. The recommended anchor and screw specifications are as follows.
Anchor: Outer diameter 6.0 mm, Length 26.4 mm
Screw: PA3*14 mm (Head diameter: 5.2 mm, Head thickness: 1.8 mm)

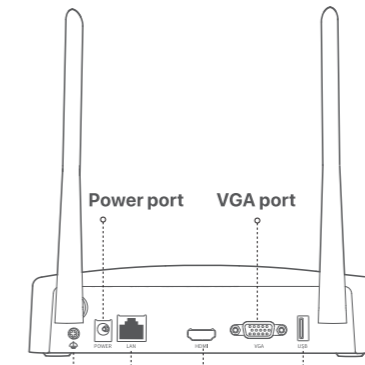

Grounding terminal 10/100 Mbps auto-negotiation Ethernet port HDMI port VGA port USB2.0 port

Ports	Description
	Grounding terminal. Connect the grounding terminal of the NVR to the earth or the grounding terminal of the building with a grounding cable to prevent static electricity or lightning from damaging the NVR.
POWER	Power port. Use the included 12 V 2 A power adapter to power on the NVR.
LAN	10/100 Mbps auto-negotiation Ethernet port. Used for connecting the router, switch, etc.
HDMI	HDMI port. Connect your monitor or TV to this port using an HDMI cable for high-definition audio and video output.
VGA	VGA port. Connect your monitor to this port using a VGA cable for video signals.
USB	USB 2.0 port. Used for connecting a mouse, an USB storage device, etc.

▪ Camera

- LED indicator**
- Solid red:** Initializing and starting.
 - Blinking red slowly:** Disconnected from a 2.4 GHz Wi-Fi network.
 - Blinking red quickly:** Connecting to the NVR.
 - Solid blue:** Connected to the NVR.
 - Blinking blue slowly:** Upgrading.
 - Blinking blue quickly:** Waiting to connect to a 2.4 GHz Wi-Fi network.

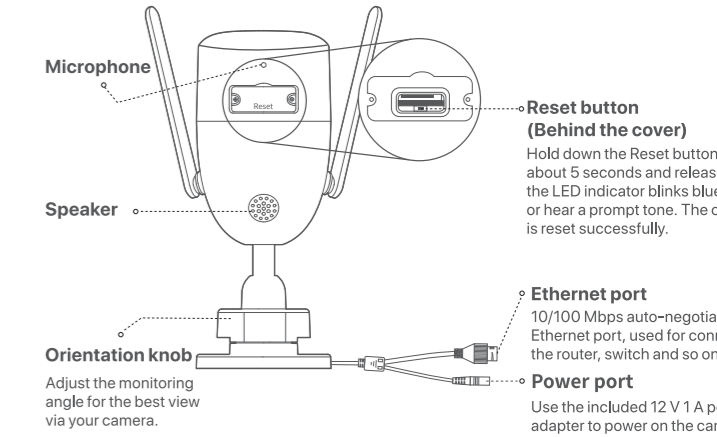
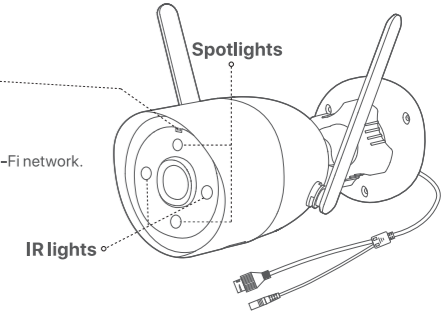

Reset button (Behind the cover)
Hold down the Reset button for about 5 seconds and release it when the LED indicator blinks blue quickly or hear a prompt tone. The camera is reset successfully.

Ethernet port
10/100 Mbps auto-negotiation Ethernet port, used for connecting the router, switch and so on.

Power port
Use the included 12 V 1 A power adapter to power on the camera.

1 Install the HDD

- Tips**
- This kit does not include any HDD. Please prepare it by yourself. It is recommended to use the HDD dedicated for surveillance.
 - When installing or replacing the HDD, please cut off the power of the NVR, otherwise the HDD may not be detected or even be damaged.
 - You may need a screwdriver. Please prepare it by yourself.

1 Unfasten the screws on the bottom, then remove the cover of the NVR. Reserve the screws for later use.

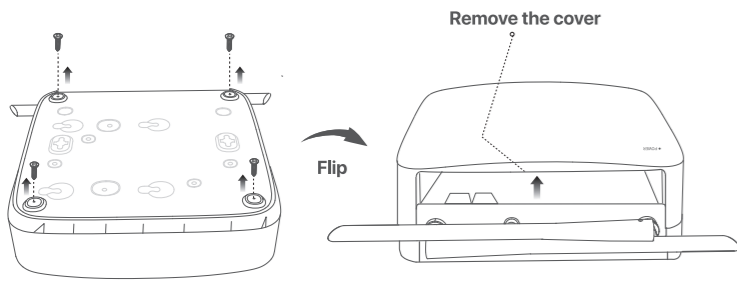

3 Align the SATA connector of the HDD with the SATA slot on the motherboard of the NVR, and then insert the HDD into the slot until it is tightly fixed.

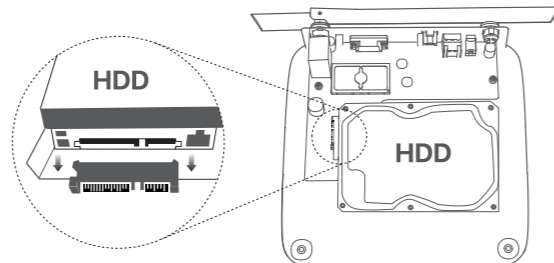

5 Mounting the cover with the previously removed screws.

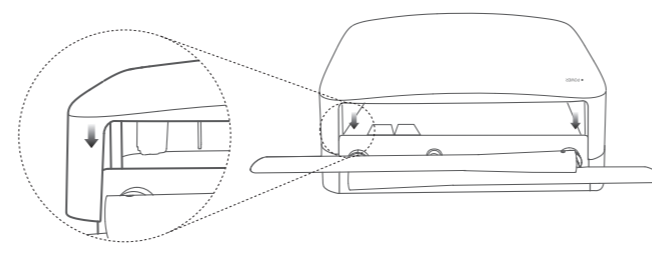

2 Take out 2 screws from the NVR installation package, and screw them into the two screw holes closest to the SATA connector. Reserve about 2 mm between the screw head and the HDD for subsequent installation.

4 Take out the remaining screws from the NVR installation package, and screw them into the HDD screw holes to fix the HDD.

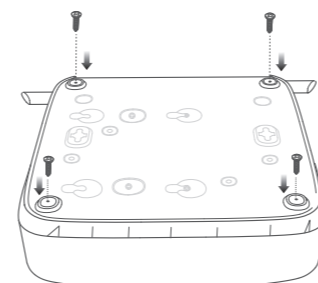
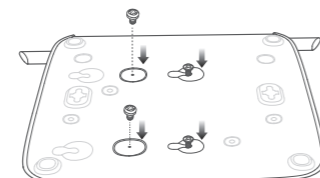
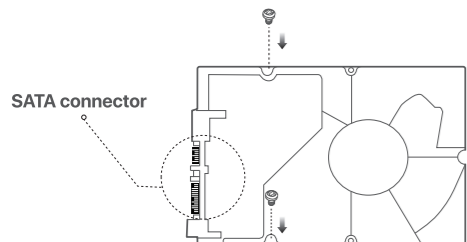

2 Connect the device

The K8W-3TC kit is taken as an example here.

Place all cameras near the NVR, and power on the cameras first (12 V 1 A), then power on the NVR (12 V 2 A).

The cameras and the NVR will automatically establish connections within 2 minutes. When the LED indicator of the cameras turn solid blue, the NVR successfully adds the cameras and starts recording.

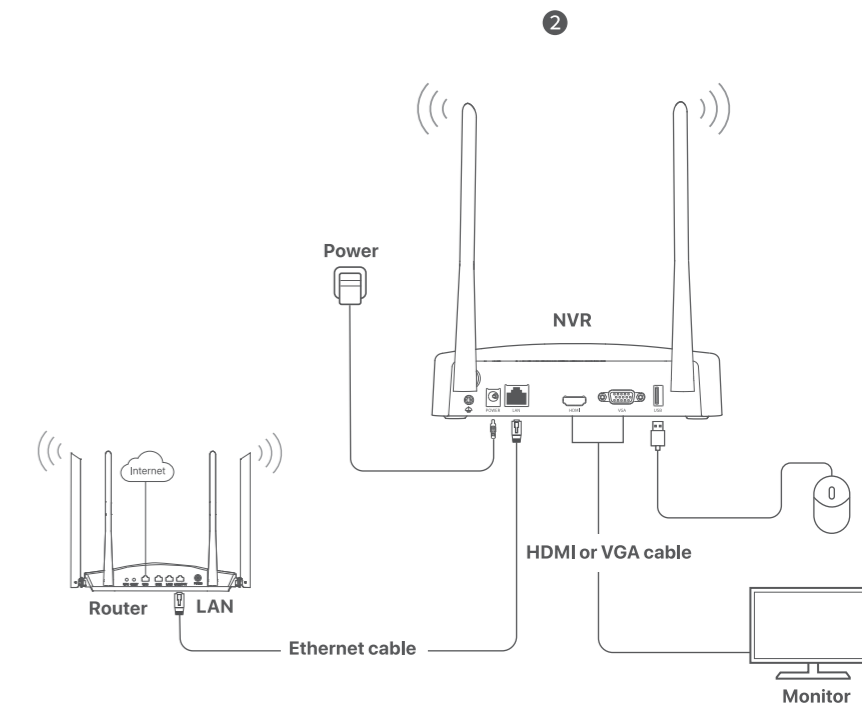
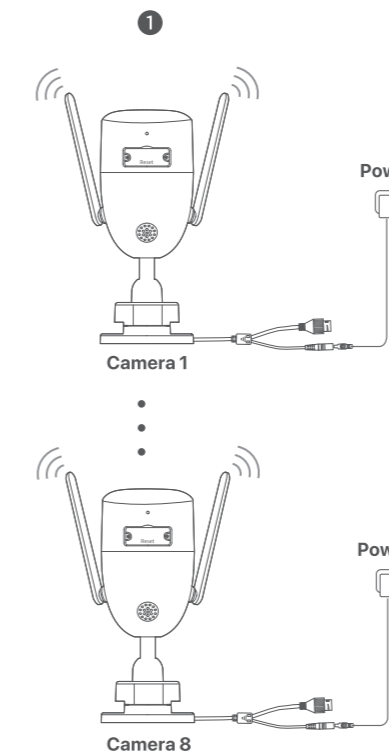

Tips
If the NVR fails to automatically add cameras, refer to Q1 in FAQ.

3 Install the camera

Install the camera to the monitoring location as required.

- The camera needs to be placed within the wireless coverage of the NVR.
- The distance between the NVR/camera and the wireless router, induction cooker, microwave oven, and refrigerator should be more than 1 meter.
- The antennas of the NVR and the camera are placed vertically.

Fix the camera

The camera supports ceiling and wall installation.

- Tips**
- Please make sure the ceiling is strong enough to withstand three times the weight of the camera.
- You may need to prepare a hammer drill, a drill bit, a rubber hammer, a screwdriver, and a ladder for the installation.

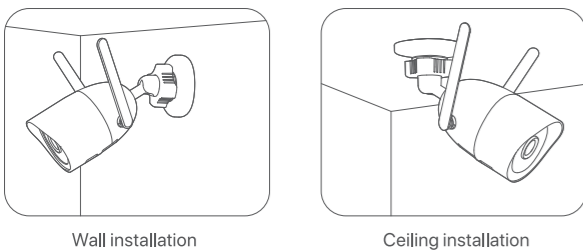
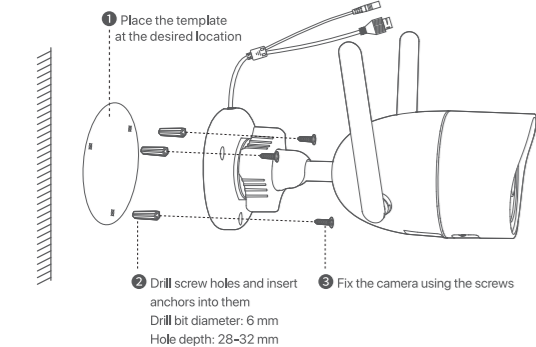

App management

After the cloud service of the NVR is enabled and the cloud status is online, you can add and manage the NVR through the TDSEE App.

- Download the TDSEE App. After the mobile phone is connected to the internet successfully, download and install the TDSEE App onto your mobile phone by scanning the QR code or by searching for TDSEE in the Google Play or App Store.



- Ensure that the NVR is powered on and working properly.

- Run the TDSEE App and follow the instructions to complete user registration. Enter the Home page, then tap Add a device or in the upper right corner of the home page.

- Note**
To ensure that the login password of the NVR can be reset through the TDSEE App, please register with the reserved email address when activated the NVR.

- Scan the QR code on the label at the bottom of the NVR or scan the QR code on the Cloud Service page, then follow the instructions in the App.

After added the NVR, you can remotely preview real-time video, play back the recordings and check alarm messages through the TDSEE App.

4 Basic configuration

Local management

Startup

- Tips**
Use the included power adapter to power on the NVR. Abnormal power supply will damage the device.

Connect the 12 V 2 A power adapter to the power port of the NVR, and plug the power adapter into the power socket to start up the NVR.

Shut Down

- Note**
Do not directly cut off the power of the NVR to force a shutdown, otherwise it may damage the HDD, lead to the loss of videos, or even damage the NVR.

After connecting the mouse and monitor to the NVR, perform the following settings on the NVR's management page (exit the Full Screen interface):

Click in the upper right corner, click Shut Down, and then click OK. When The Device is Shut Down. Please Cut Off the Power appears on the screen, unplug the power adapter of the NVR.

Quick setup

After connecting the mouse and monitor to the NVR, you can perform quick setup.

- Set Login Password, enter your Email Address, then click Activate.

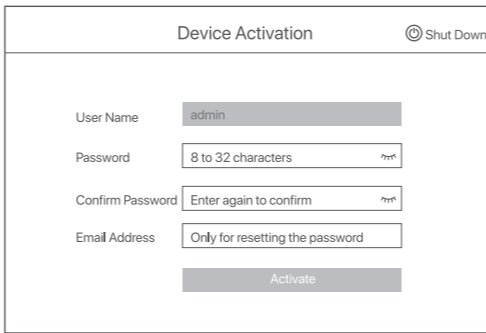

Adjust the monitoring angle

Loosen the orientation knob, adjust the orientation of the camera as required, then tighten the knob.

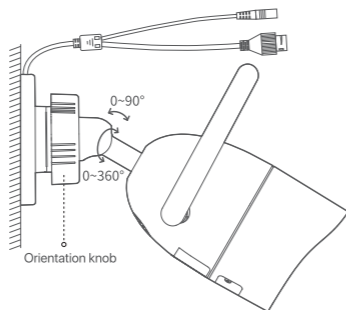

Install waterproof kit

Install the waterproof kit and wrap the end with waterproof tape for the Ethernet port and power port if the camera is installed outdoors.

- Note**
The included waterproof kit is not suitable for the Ethernet cable with protection cover on the crystal head. See the example on the right.

Please follow the steps below to install the waterproof kit when the Ethernet port of the camera is connected to an Ethernet cable.

- Put the O-ring on the Ethernet port of the camera.
- Pass the Ethernet cable through the fix nut, the waterproof ring and the waterproof jacket in proper order. Then connect it to the Ethernet port of the camera.
- Rotate to fix the waterproof jacket to the Ethernet port of the camera, insert the waterproof ring into the waterproof jacket and fasten the fix nut.

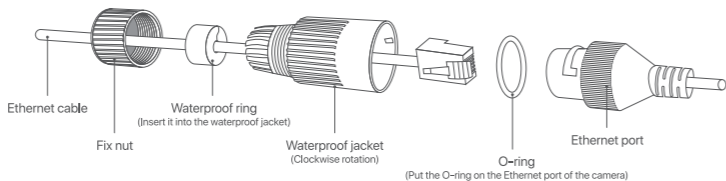

FAQ

Q1. What should I do if the NVR fails to automatically add the camera?

- Try the following solutions:
 - Ensure that the LED indicator of the NVR is on, if the LED indicator is off, please check the power supply.
 - Ensure that the LED indicator of the camera is blinking blue quickly, if not, please reset the camera and try again.
 - Reset method:** Hold down the Reset button for about 5 seconds and release it when the LED indicator blinks blue quickly or you hear a prompt tone.
 - Add the camera on the management page of the NVR.

Q2. What should I do when the video preview is not smooth or the camera is often offline?

- Try the following solutions:
 - Ensure that the distance between the NVR/camera and the wireless router, induction cooker, microwave oven, and refrigerator is more than 1 meter.
 - If the distance is too far between the NVR and the camera, please adjust the location of the NVR or the camera to shorten the distance.
 - If there are too many obstacles (such as walls, glass doors, etc.) between the NVR and the camera, please adjust the location of the NVR or the camera to reduce the obstacles.

Q3. How to add a new camera when the NVR is under stable operation?

- Please ensure that the number added cameras has not reached the limit. Then try the following steps:
 - Ensure that the new camera is under default settings. If not, please reset it first.
 - Place the new camera near the NVR and power it on.
 - The NVR will automatically detect the camera. Add the camera after you verify the S/N on the pop-up window is correct.
 - Unplug the power of the camera and install the camera to the monitoring location as required.

Q4. What should I do if there is no video for playing back on the NVR?

- Try the following solutions:
 - Ensure that the HDD is working properly.
 - Navigate to **Settings > Storage Management > HDD Management**:
 - If the HDD is not detected, please shut down the NVR first, reinstall the HDD and start up the NVR.
 - If the HDD is under abnormal status, please shut down the NVR first, reinstall the HDD and start up the NVR. If the problem persists, please format the HDD.
 - If the formatting fails, please shut down the NVR first, replace the HDD and start up the NVR.
 - Ensure that the recording plan is normal.
 - Navigate to **Settings > Storage Management > Recording Schedule**, ensure that:
 - The channel recording schedule is enabled.
 - The recording time and recording type have been set properly. If not, please set and save according to the actual situation.

- If you want to use a pattern to unlock the management page, please draw an unlock pattern. Otherwise, click Do Not Use Unlock Pattern and skip to step 3.

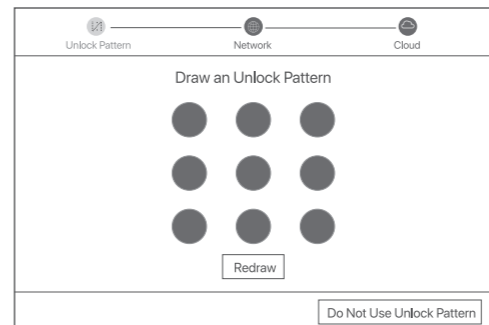

- Ensure that the connection status is Connected, then click Next.

- Tips**
If the connection status is Disconnected, try the following solutions:
 - Ensure that the LAN port connection of the NVR is normal.
 - Ensure that the DHCP server function of the router to which the NVR is connected is enabled.

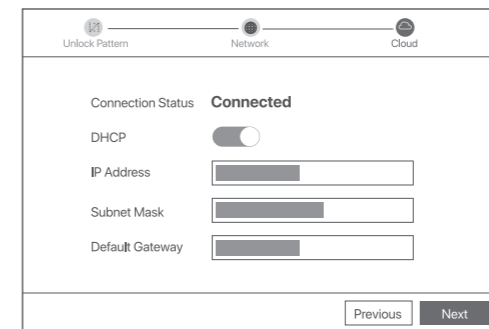

Caution (N3W-4H & N3W-8H):

Adapter Model: BN026-A24012E, BN026-A24012B
 Manufacture: SHENZHEN HEWEISHUN NETWORK TECHNOLOGY CO., LTD.
 Input: 100-240V AC, 50/60Hz 0.7A
 Output: 12V DC, 2A
 --- : DC Voltage

Camera is used outdoors. NVR and Adapter are used indoors.



This product bears the selective sorting symbol for Waste electrical and electronic equipment (WEEE). This means that this product must be handled pursuant to European directive 2012/19/EU in order to be recycled or dismantled to minimize its impact on the environment. User has the choice to give his product to a competent recycling organization or to the retailer when he buys new electrical or electronic equipment.

Operating Temperature: -30°C - 60°C (KCT6)
 Operating Humidity: (10% - 95%) RH, non-condensing (KCT6)
 Operating Temperature: -0°C - 40°C (N3W-4H & N3W-8H)
 Operating Humidity: (10% - 90%) RH, non-condensing (N3W-4H & N3W-8H)



FCC Statement (KCT6)

This equipment has been tested and found to comply with the limits for a Class A digital device, pursuant to Part 15 of the FCC Rules. These limits are designed to provide reasonable protection against harmful interference when the equipment is operated in a commercial environment. This equipment generates, uses, and can radiate radio frequency energy and, if not installed and used in accordance with the instruction manual, may cause harmful interference to radio communications. Operation of this equipment in a residential area is likely to cause harmful interference in which case the user will be required to correct the interference at his own expense. Operation is subject to the following two conditions: (1) this device may not cause harmful interference, and (2) this device must accept any interference received, including interference that may cause undesired operation.

Radiation Exposure Statement

This device complies with FCC radiation exposure limits set forth for an uncontrolled environment and it also complies with Part 15 of the FCC RF Rules. This equipment should be installed and operated with minimum distance 20cm between the device and your body.

Caution!
Any changes or modifications not expressly approved by the party responsible for compliance could void the user's authority to operate the equipment.

This transmitter must not be co-located or operating in conjunction with any other antenna or transmitter. Operating frequency: 2412-2462MHz

NOTE: (1) The manufacturer is not responsible for any radio or TV interference caused by unauthorized modifications to this equipment. (2) To avoid unnecessary radiation interference, it is recommended to use a shielded RJ45 cable.

- Ensure that the cloud status is Online and click OK.

- Tips**
- If the cloud status is Offline, please ensure that the router to which the NVR is connected can access the internet and the filter function is disabled.
- You can also manage the NVR through the TDSEE App. Please refer to App Management in this guide for details.

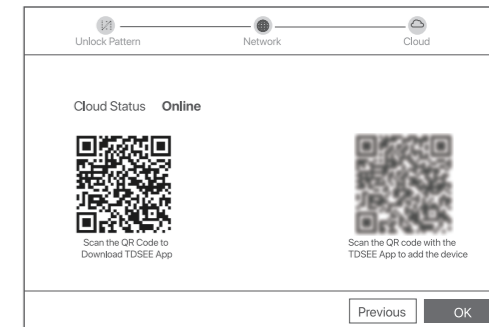

Settings completed. You can preview real-time video, play back the recordings and manage monitoring devices, etc.



FCC Statement (N3W-4H & N3W-8H)

This equipment has been tested and found to comply with the limits for a Class B digital device, pursuant to Part 15 of the FCC Rules. These limits are designed to provide reasonable protection against harmful interference in a residential installation. This equipment generates, uses and can radiate radio frequency energy and, if not installed and used in accordance with the instructions, may cause harmful interference to radio communications. However, there is no guarantee that interference will not occur in a particular installation. If this equipment does cause harmful interference to radio or television reception, which can be determined by turning the equipment off and on, the user is encouraged to try to correct the interference by one or more of the following measures:

- Reorient or relocate the receiving antenna.
- Increase the separation between the equipment and receiver.
- Connect the equipment into an outlet on a circuit different from that to which the receiver is connected.
- Consult the dealer or an experienced radio/TV technician for help.

 Operation is subject to the following two conditions: (1) this device may not cause harmful interference, and (2) this device must accept any interference received, including interference that may cause undesired operation.

Radiation Exposure Statement

This device complies with FCC radiation exposure limits set forth for an uncontrolled environment and it also complies with Part 15 of the FCC RF Rules. This equipment should be installed and operated with minimum distance 20cm between the device and your body. **Caution:** Any changes or modifications not expressly approved by the party responsible for compliance could void the user's authority to operate this equipment. This transmitter must not be co-located or operating in conjunction with any other antenna or transmitter. Operating frequency: 2412-2462MHz **NOTE:** (1) The manufacturer is not responsible for any radio or TV interference caused by unauthorized modifications to this equipment. (2) To avoid unnecessary radiation interference, it is recommended to use a shielded RJ45 cable.



Technical Support

Shenzhen Tenda Technology Co., Ltd.
 6-8 Floor, Tower E3, NO.1001, Zhongshanyuan Road, Nanshan District, Shenzhen, China. 518052
 USA hotline: 1-800-570-5892
 Toll Free: 7 x 24 hours
 Canada hotline: 1-888-998-8966
 Toll Free: Mon - Fri 9 am - 6 pm PST
 Hong Kong hotline: 00852-81931998
 Global hotline: +86 755-2765 7180 (China Time Zone)
 Website: www.tendacn.com
 E-mail: support@tenda.com.cn

Copyright

© 2021 Shenzhen Tenda Technology Co., Ltd. All rights reserved. Tenda is a registered trademark legally held by Shenzhen Tenda Technology Co., Ltd. Other brand and product names mentioned herein are trademarks or registered trademarks of their respective holders. Specifications are subject to change without notice.